



Mudford Lane

DenisonS

DenisonS

# 12 Mudeford Lane

Christchurch, BH23 3HL

£399,950

Nestled in the stunning location of Mudeford, lies an exquisite semi-detached house with two bedrooms that has been meticulously designed to an exceptional standard.

As you step into the entrance hall, you are greeted by a bright and airy lounge with an inviting open fireplace, perfect for cozy evenings. The lounge leads to a second hallway that opens up to a breathtaking kitchen, complete with modern amenities and side access. Moreover, there is a quaint study area that could easily be converted into a convenient utility room. The hallway also leads to a charming conservatory that overlooks a spacious garden, ideal for unwinding and relaxing. Upstairs, you will find two elegantly designed bedrooms that are filled with natural light. The master bedroom is larger than the second room and boasts a stunning bathroom that has been thoughtfully designed to provide the ultimate relaxation experience.

The garden is a great space for hosting social gatherings with friends and family, with a well-designed cabin/shed at the end, perfect for storage or as a workshop.

The property also benefits from a large driveway that can accommodate several vehicles, with gated access to the rear garden providing privacy and security.



**Sitting Room 11' 0" x 12' 6" (3.35m x 3.81m)**

**Kitchen 9' 3" x 9' 0" (2.82m x 2.74m)**

**Study 6' 0" x 6' 0" (1.83m x 1.83m)**

**Conservatory 11' 4" x 6' 0" (3.45m x 1.83m)**

**bedroom 1 11' 0" x 15' 4" (3.35m x 4.67m)**

**Bedroom 2 9' 3" x 6' 10" (2.82m x 2.08m)**

**Bathroom 6' 6" x 0' 0" (1.83m x 1.83m)**



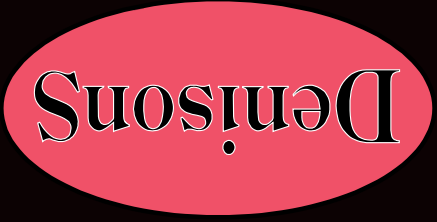

Denisons for themselves and for the Vendors or lessors of this property, whose Agents they are, give notice that these particulars are produced in good faith, are set out as a general guide only and do not constitute any part of a Contract. No person in the employment of Denisons has any authority to make or give any representation or warranty whatever in relation to this property.

[www.denisons.com](http://www.denisons.com)

Mayfair  
 Cashel House, London, W1U 3JT  
**0870 112 7099**  
[mayfair@denisons.com](mailto:mayfair@denisons.com)

Christchurch  
 12 Castle Street, Christchurch BH23 1DT  
**01202 484748**  
[christchurch@denisons.com](mailto:christchurch@denisons.com)

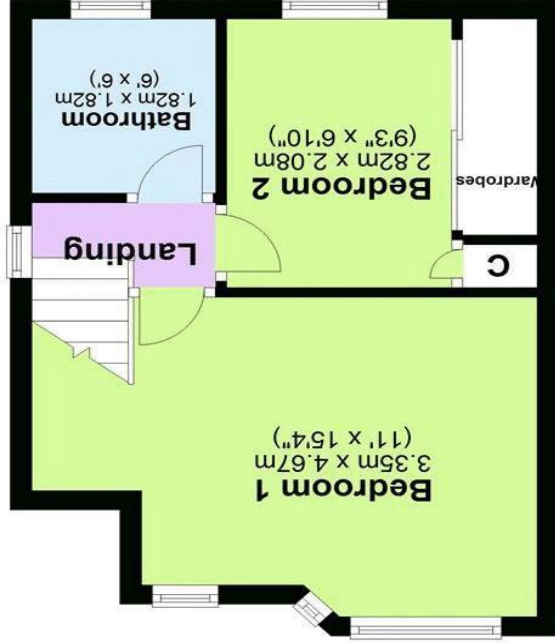

First Floor

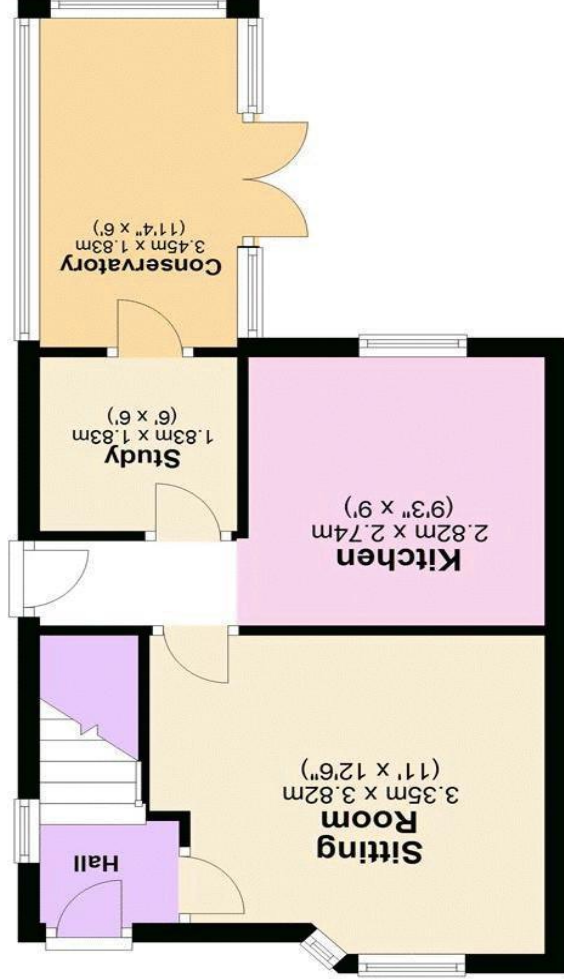

Ground Floor